



LogistiCenter
at
Sauk Village

**21750 Jason Rasmussen Drive
 Sauk Village, Illinois**

496,260 SF Rail-Served Building



DP | **DERMODY PROPERTIES**



For additional information,
 please contact:

Chris Gary
 Vice President
 cgary@darwinrealty.com

George J. Cibula, SIOR
 President
 gcibula@darwinrealty.com

Ryan C. Hanley
 Associate
 rhanley@darwinrealty.com

970 N. Oak Lawn Avenue
 Suite 100
 Elmhurst, IL 60126

Tel: 630-782-9520
 Fax: 630-782-9531
 www.darwinrealty.com

Building Specifications

Building Size	496,260 SF (expandable to 1,170,000 SF)
Divisible to:	100,000 SF
Office:	To Suit
Land:	325 Acre Logistics Park
Ceiling Height:	32' Clear
Loading:	50 Exterior Docks (expandable to 120) 2 Drive-in Doors; 12 Rail Doors
Column Spacing:	50' x 50' / 60' Loading Bays
Power:	4,000 Amps, 277/480 Volt, 3-Phase
Parking:	59 Trailer spots / 184 cars spots (expandable)
Sprinkler:	ESFR
Heat:	Gas fired units
Flooring:	7" 4,000 lb. slab, reinforced control joints
Rail:	Canadian National
Lighting:	High-efficiency T-5 Fluorescent
Lease Rate:	\$3.95 psf Gross
Sale Price:	\$19,600,000 (\$39.50 psf)

Comments

- Available for Immediate Occupancy
- Cook County Class 8 designation and Enterprise Zone status
- Located off I-394, 5 miles south of I-80/I-94
- Prime location for cost-effective distribution

Submitted subject to error, change in status, or withdrawal without notice.



LogistiCenter[®]
at
Sauk Village

**21750 Jason Rasmussen Drive
 Sauk Village, Illinois**

For additional information,
 please contact:

Chris Gary
 Vice President
 cgary@darwinrealty.com

George J. Cibula, SIOR
 President
 gcibula@darwinrealty.com

Ryan C. Hanley
 Associate
 rhanley@darwinrealty.com

970 N. Oak Lawn Avenue
 Suite 100
 Elmhurst, IL 60126

Tel: 630-782-9520
 Fax: 630-782-9531
 www.darwinrealty.com

LAYOUT

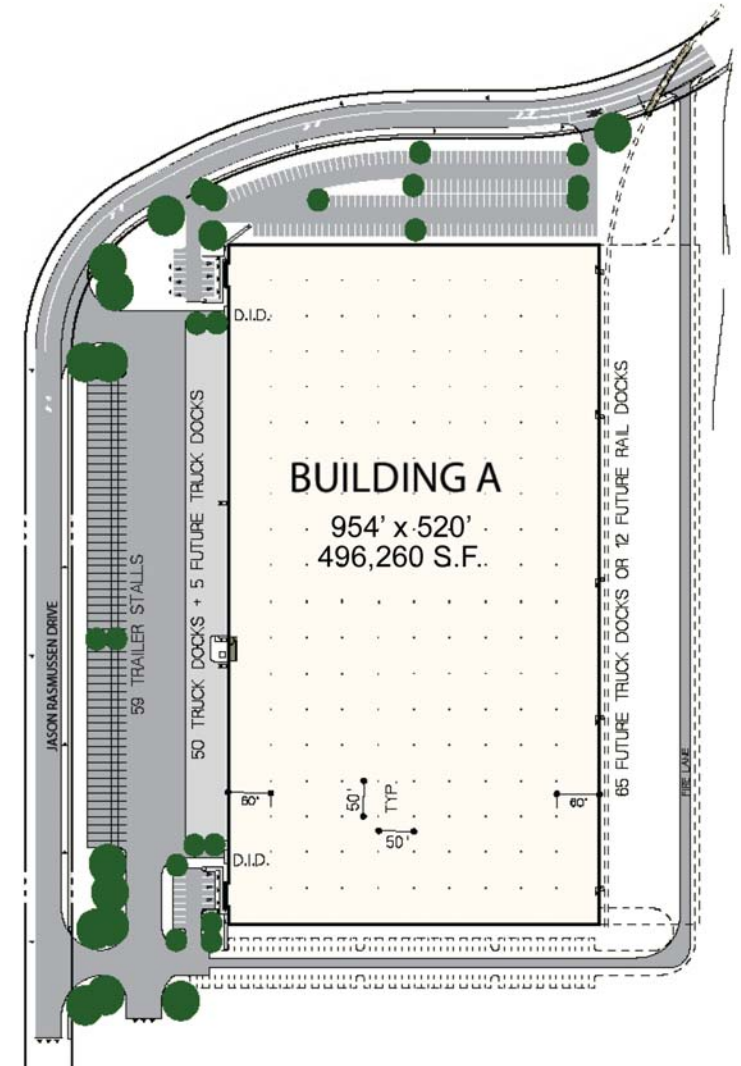

Submitted subject to error, change in status, or withdrawal without notice.